

Copyright. All information furnished within this document, electronic file or design correspondence is the property of Den Hartog industries, Inc. and shall not be used, disclosed to others or copied without the expressed written consent of Den Hartog Industries, Inc.

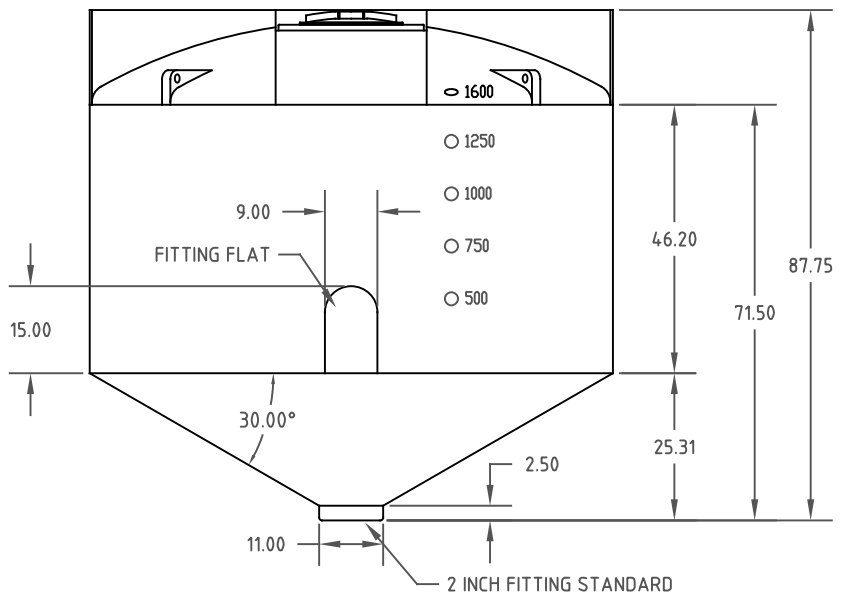

		DRAWN / DATE DHJ 1/3/11		MATERIAL 104-20 3 MELT	
A WAS 90		DHJ 5/11/17 3385		APPRD. / DATE REH 2/2/11	
REV	DESCRIPTION	BY / DATE	CCN	SHOT WEIGHT: 284 LBS.	
ALL DIMENSIONS ARE IN DECIMAL INCHES TOLERANCES UNLESS OTHERWISE SPECIFIED				SHIPPING WEIGHT: 286 LBS.	
POLYETHYLENE ±1% @ 68° F		THIRD ANGLE PROJECTION ANSI 14.5M		NOTES: 1. THICKNESS @ BOTTOM SIDEWALL .326	
METAL DECIMAL ± .125" FRACTION ± 1/4" ANGLE ± 1°				FINISH:	

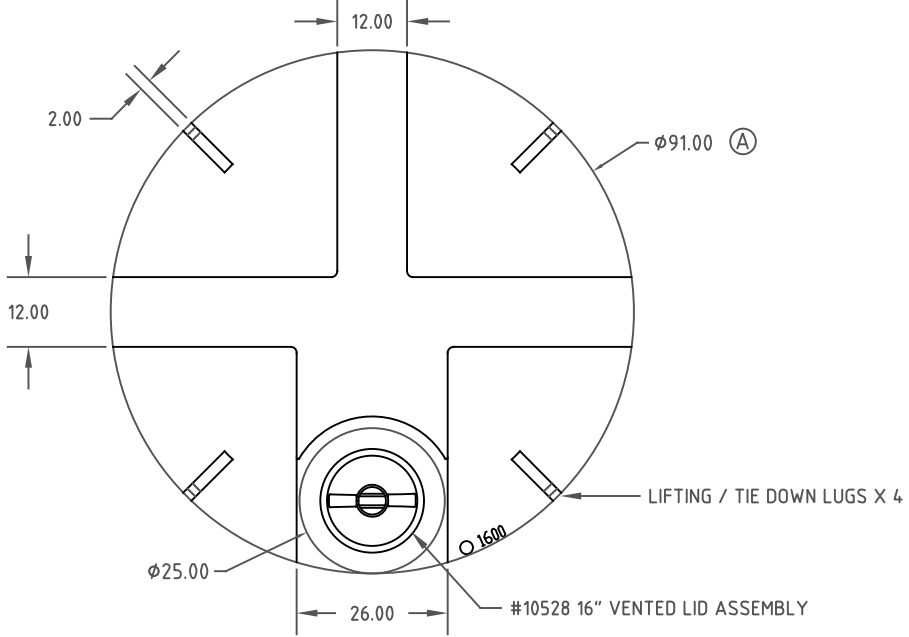

**Den Hartog**  
INDUSTRIES, INC.

Ace Roto-Mold Injection Molding Blow Molding SowJoy  
4010 HOSPERS DRIVE S. BOX 425, HOSPERS, IOWA 51238-0425

DESCRIPTION 1550 GALLON 90" DIA. X 30° CONE BOTTOM TANK W/ INDUSTRIAL TOP	
SCALE N.S.	PART NO. CB1550-90

Copyright. All information furnished within this document, electronic file or design correspondence is the property of Den Hartog industries, Inc. and shall not be used, disclosed to others or copied without the expressed written consent of Den Hartog Industries, Inc.

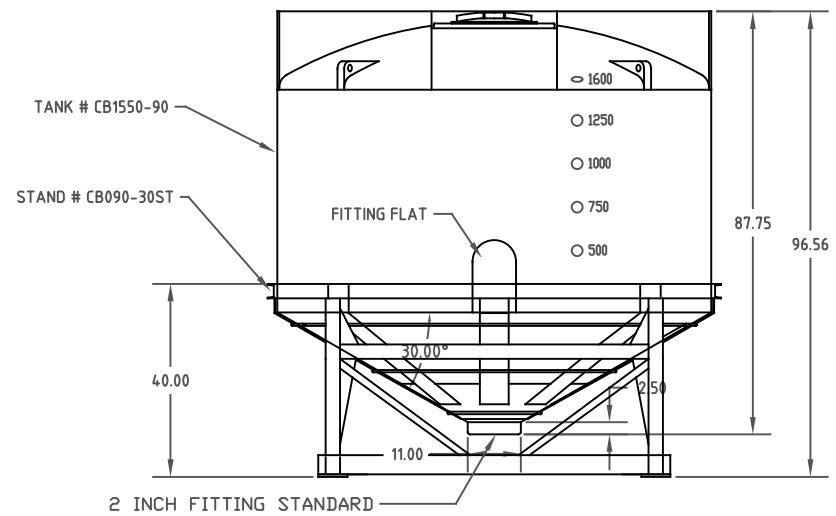
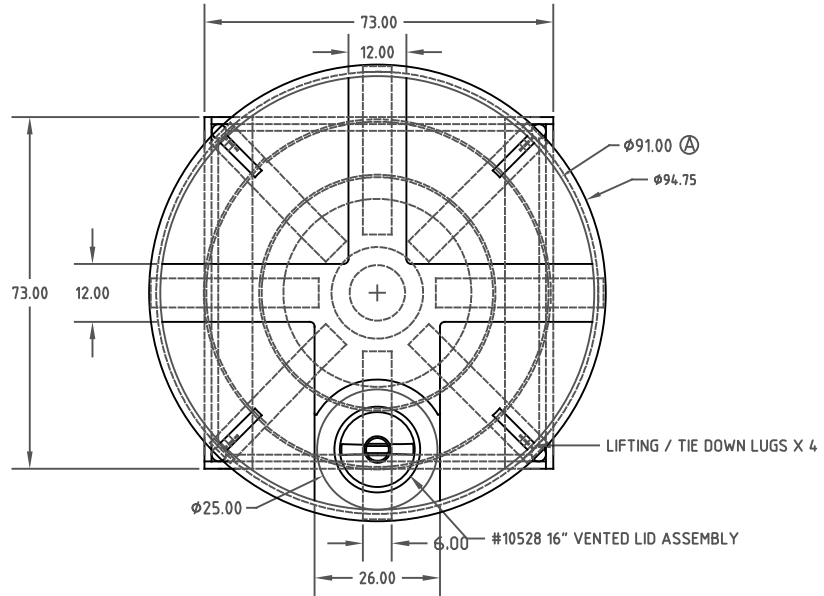

		DRAWN / DATE DHJ 1/3/11		MATERIAL TANK 10420 3 MELT STAND MILD STEEL	
		APPRD. / DATE REH 1/3/11			
A	WAS 90	DHJ 5/11/17	3385		
REV	DESCRIPTION	BY / DATE	CCN		
ALL DIMENSIONS ARE IN DECIMAL INCHES TOLERANCES UNLESS OTHERWISE SPECIFIED		THIRD ANGLE PROJECTION ANSI 14.5M		SHOT WEIGHT: SHIPPING WEIGHT: FINISH:	
POLYETHYLENE ±1% @ 68° F		METAL DECIMAL ± .125" FRACTION ± 1/4" ANGLE ± 1°		926 LBS.	
				NOTES: 1. THICKNESS @ BOTTOM SIDEWALL .326	



# Den Hartog

INDUSTRIES, INC.

Ace Roto-Mold Injection Molding Blow Molding SowJoy  
4010 HOSPERS DRIVE S. BOX 425, HOSPERS, IOWA 51238-0425

DESCRIPTION 1550 GALLON 90" DIA. X 30° CONE BOTTOM TANK W/ INDUSTRIAL TOP AND STAND	
SCALE N.S.	PART NO. CB1550-90+90-30ST